

# ECLISSE SYNTESIS® BASEBOARD

## TECHNICAL DETAILS



The ECLISSE SYNTESIS® BASEBOARD is an innovative idea to decorate house spaces in an elegant, minimal, modern way. Unlike traditional skirting boards, this profile allows to install a perfectly flush-to-the-wall skirting that runs along the wall without protruding. This way, furniture can be placed adherent to the wall, without remodelling the baseboard or leaving annoying gaps between the furniture and the wall.

The principle is simple: it is simply necessary to create a hollow for the baseboard by placing the special aluminium profiles while creating the wall structure. The ultimate expression of the ECLISSE SYNTESIS® FLUSH concept.

### Aesthetics

To fix the profiles to a solid wall a structural sealing adhesive is needed.

In the case of stud walls the profiles, specifically perforated, are to be fixed with screws.

### Technical features and finishes

The aluminium profiles have a triple-chamber structure that assures robustness and allows a perfect union between two different bars thanks to the special connecting joints.

### Application

The profiles fit with the insertion of standard baseboards (max. height: 58 mm).

For higher baseboards, simply place the profiles higher than the finished floor level.

## APPLICATIONS

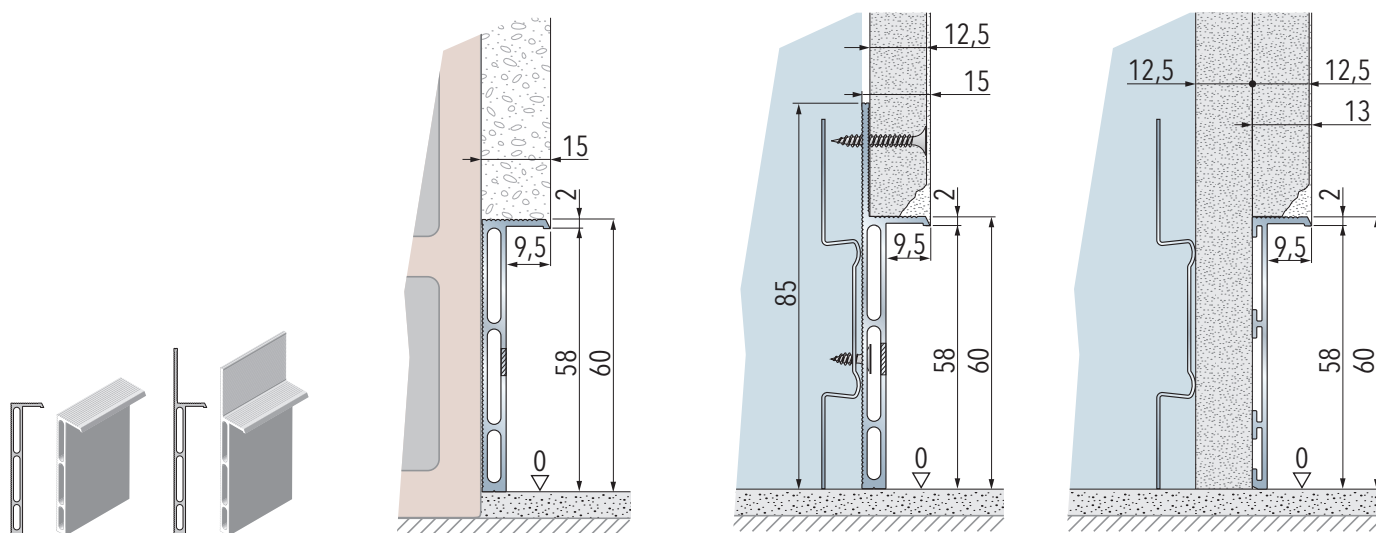

The aluminium profile is supplied in 2000 mm long bars.  
Useful space in height for the baseboard: 58 mm

Baseboard installed on solid wall

Baseboard installed on stud wall (one layer of plasterboard)

Baseboard installed on stud wall (two layers of plasterboard)

Dimensions are given in mm

# ECLISSE SYNTESIS® BASEBOARD

## TERMINAL ELEMENTS AND CONNECTING JOINTS

### TERMINAL ELEMENTS (different versions for solid wall and stud wall)

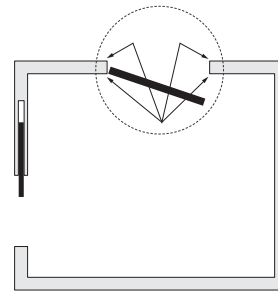
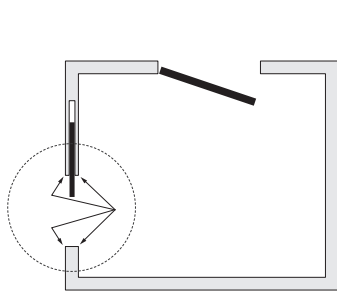

ALUMINIUM END PROFILES FOR SYNTESIS® FLUSH POCKET DOORS

ALUMINIUM END PROFILES FOR SYNTESIS® FLUSH HINGED DOORS

### JOINTS FOR CONNECTING PROFILES

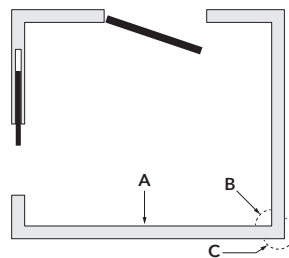

LINEAR JOINT\*

JOINTS FOR INTERNAL CORNER

JOINTS FOR EXTERNAL CORNER

JOINT FOR STEPS\*

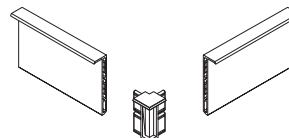
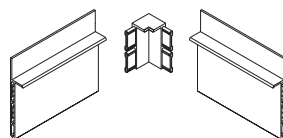
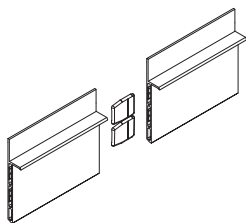
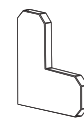
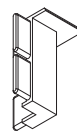
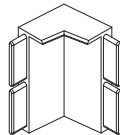
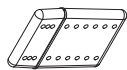

PACK OF 10 JOINTS

PACK OF 50 JOINTS  
(see item A in the figure)

PACK OF 10 JOINTS  
(see item B in the figure)

PACK OF 10 JOINTS  
(see item C in the figure)

### NOTES

- \* **Joints:** 2 connectors are needed for each profile to be connected.
- ▶ Terminal profiles are needed for ECLISSE SYNTESIS® FLUSH doors, ECLISSE 40 doors and ECLISSE SYNTESIS® AREO.
- ▶ Adhesive sealant: for solid walls use one packet per 25 linear metres.

# ECLISSE SYNTESIS® BASEBOARD

## LEDs - FINISHES

### APPLICATION OF LED LIGHTING (LED strip not provided)

ECLISSE SYNTESIS® BASEBOARD can function as a step marker if backlit with LEDs.

- The baseboard (skirting) must be milled on the top of the rear side: 25 mm from the top, 4 mm in depth (see picture).
- Fix the LED strip on the profile in the space left by the milling.
- The baseboard height must be reduced by 2 mm to allow the light to pass through.

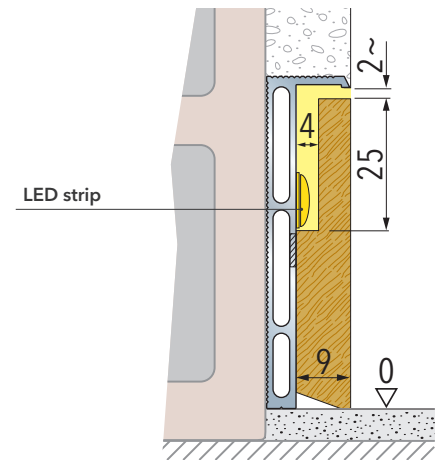

### FINISHES

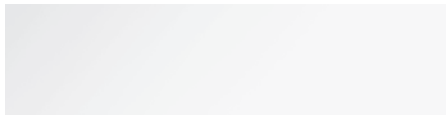

PRIMER-COATED

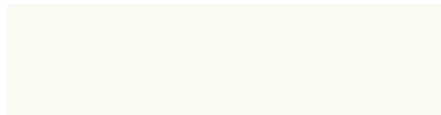

LACQUERED WHITE RAL 9010



LACQUERED IN OTHER RAL COLOURS



NATURAL ASH



WHITE ASH

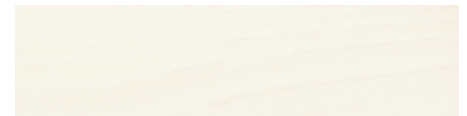

OPEN PORE LACQUERED WHITE RAL 9010 ASH



NATURAL OAK

Dimensions are given in mm