

# ECLISSE 40 DOUBLE

## OPENINGS

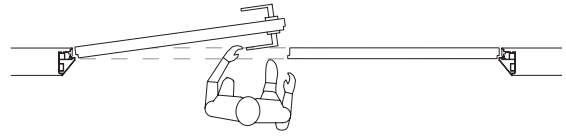

**LEFT PUSH DOOR - FIXED RIGHT DOOR**



**LEFT PULL DOOR - FIXED RIGHT DOOR**

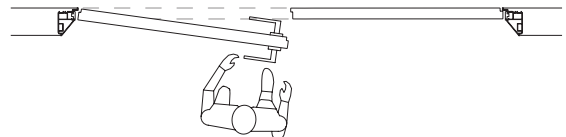

**RIGHT PUSH DOOR - FIXED LEFT DOOR**

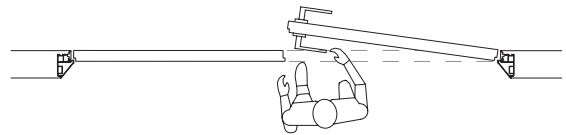

**RIGHT PULL DOOR - FIXED LEFT DOOR**

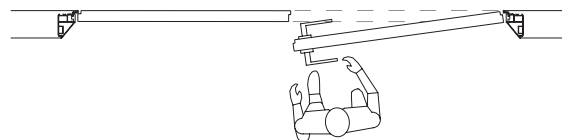

ECLISSE 40 DOUBLE is available only with header.  
The fixed door is kept closed with a latch (supplied with the door panel).

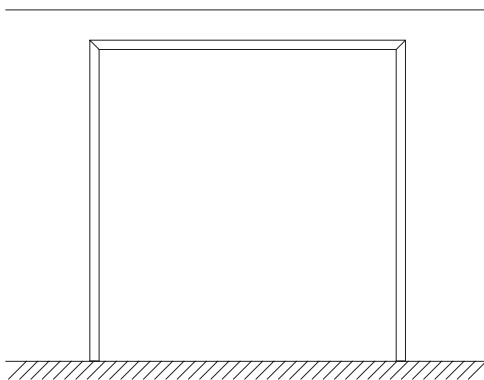

With header

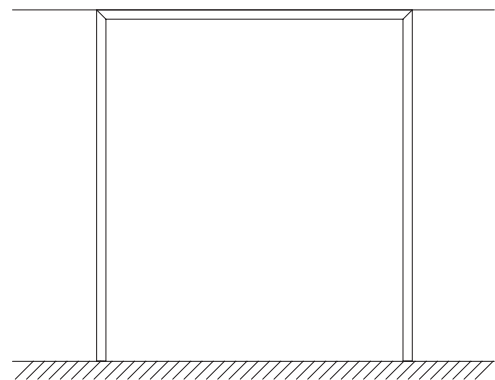

With header  
flush to ceiling

# ECLISSE 40 DOUBLE

## APPLICATIONS

Dimensions are given in mm

The frame fits both stud and solid wall.

For solid wall 6 clamps are cemented in the special spaces created in the wall.

For stud wall the frame is fixed with screws to the wood or metal structure through the existing holes.

### FIXED LEFT DOOR

### RIGHT PUSH DOOR OR PULL DOOR

#### Frame on solid wall - Finished wall thickness 108/125/150 mm

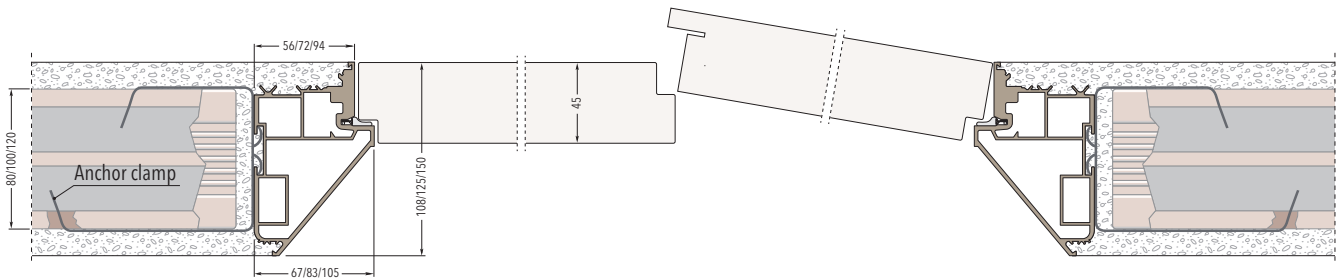

#### Frame on solid wall - Finished wall thickness 108/125/150 mm

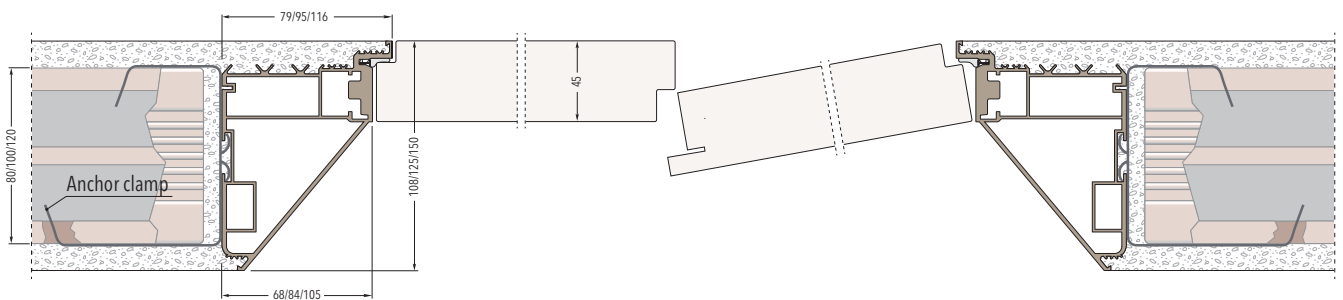

#### Frame on stud wall with one plasterboard layer - Finished wall thickness 100/125 mm

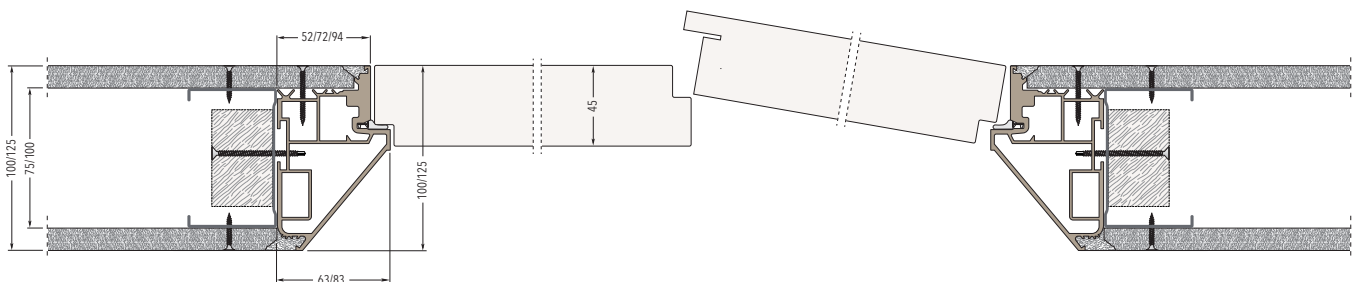

#### Frame on stud wall with two plasterboard layers - Finished wall thickness 100/125/150 mm

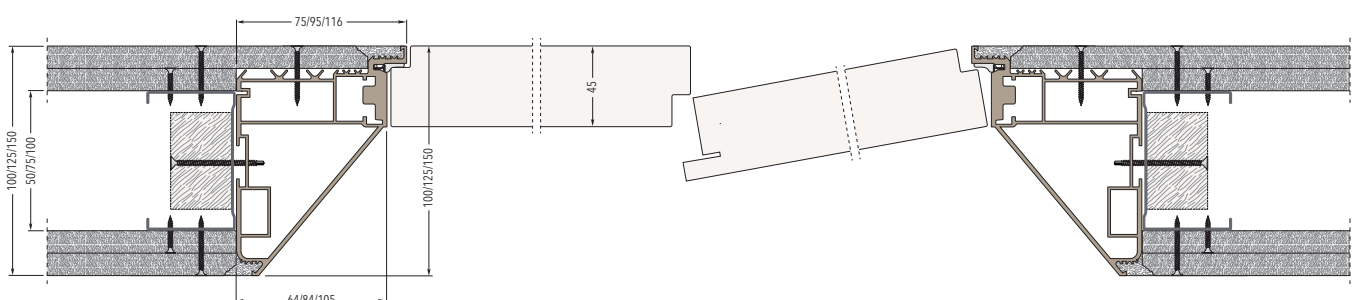

# ECLISSE 40 DOUBLE

## SIZES - FRAME WITH HEADER - PUSH DOOR

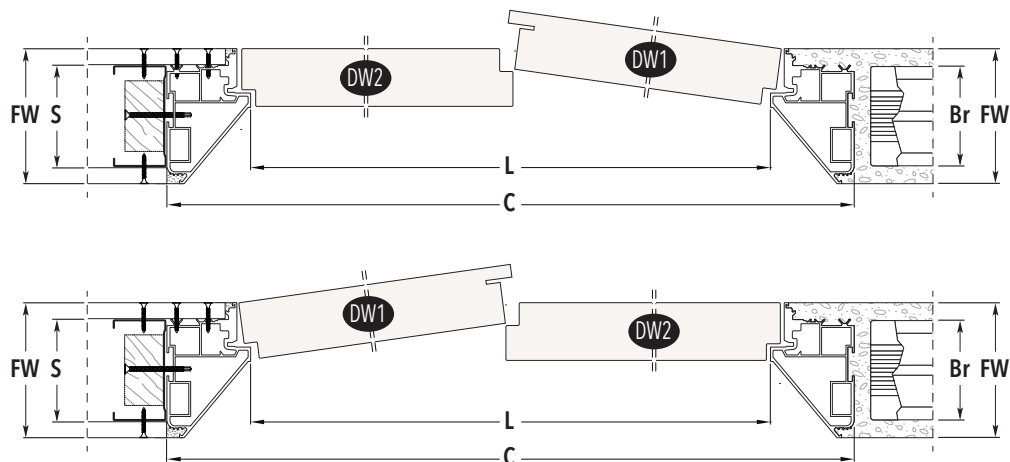
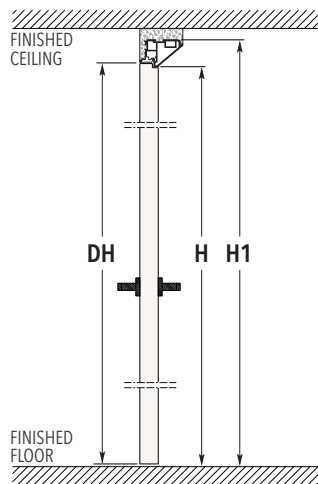

PASSAGE SIZE <b>L x H</b>	FINISHED WALL 100		FINISHED WALL 108		DOOR PANEL Thk. 45 mm		
	OVERALL DIMENSIONS <b>C x H1</b>		OVERALL DIMENSIONS <b>C x H1</b>		<b>DW1</b>	<b>DW2</b>	<b>DH</b>
	PUSH DOOR		PUSH DOOR				
1200 x 2100/2400	1326 x 2163/2463		1334 x 2167/2467		606	616	2104/2404
1400 x 2100/2400	1526 x 2163/2463		1534 x 2167/2467		706	716	2104/2404
1600 x 2100/2400	1726 x 2163/2463		1734 x 2167/2467		806	816	2104/2404
1800 x 2100/2400	1926 x 2163/2463		1934 x 2167/2467		906	916	2104/2404
2000 x 2100/2400	2126 x 2163/2463		2134 x 2167/2467		1006	1016	2104/2404

PASSAGE SIZE <b>L x H</b>	FINISHED WALL 125		FINISHED WALL 150		DOOR PANEL Thk. 45 mm		
	OVERALL DIMENSIONS <b>C x H1</b>		OVERALL DIMENSIONS <b>C x H1</b>		<b>DW1</b>	<b>DW2</b>	<b>DH</b>
	PUSH DOOR		PUSH DOOR				
1200 x 2100/2400	1366 x 2183/2483		1410 x 2205/2505		606	616	2104/2404
1400 x 2100/2400	1566 x 2183/2483		1610 x 2205/2505		706	716	2104/2404
1600 x 2100/2400	1766 x 2183/2483		1810 x 2205/2505		806	816	2104/2404
1800 x 2100/2400	1966 x 2183/2483		2010 x 2205/2505		906	916	2104/2404
2000 x 2100/2400	2166 x 2183/2483		2210 x 2205/2505		1006	1016	2104/2404

FINISHED WALL = <b>FW</b>	SOLID WALL	STUD WALL	
	BRICKS = <b>Br</b>	STUDWORK = <b>S</b>	
<b>100</b> →	--	50 with two plasterboard layers	75 with one plasterboard layer
<b>108</b> →	80	--	--
<b>125</b> →	100	75 with two plasterboard layers	100 with one plasterboard layer
<b>150</b> →	120	100 with two plasterboard layers	

Dimensions are given in mm

### NOTES

- ▶ Supplied as standard with 3 hinges. Max. door panel weight with 3 hinges: 50 kg.
- ▶ Available upon request with 4 hinges. Max. door panel weight with 4 hinges: 65 kg.
- ▶ Available finishes: Primer-coated, Champagne, Bronze, Tobacco and White RAL 9010.
- ▶ Install at finished floor level.

### ACCESSORIES

- ▶ Self-closing door hinge

# ECLISSE 40 DOUBLE

## SIZES - FRAME WITH HEADER - PULL DOOR

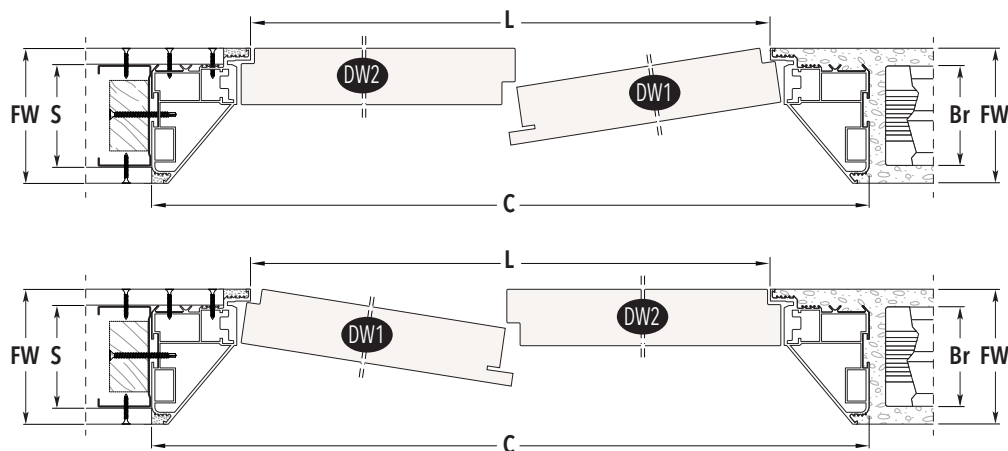
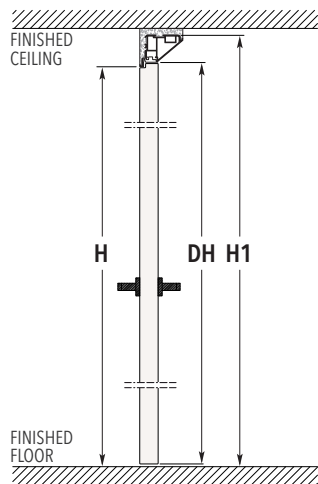

PASSAGE SIZE <b>L x H</b>	FINISHED WALL 100		FINISHED WALL 108		
	OVERALL DIMENSIONS <b>C x H1</b>		OVERALL DIMENSIONS <b>C x H1</b>		
	PULL DOOR		PULL DOOR		
			DW1	DW2	DH
1200 x 2100/2400	1350 x 2175/2475	1358 x 2179/2479	606	616	2104/2404
1400 x 2100/2400	1550 x 2175/2475	1558 x 2179/2479	706	716	2104/2404
1600 x 2100/2400	1750 x 2175/2475	1758 x 2179/2479	806	816	2104/2404
1800 x 2100/2400	1950 x 2175/2475	1958 x 2179/2479	906	916	2104/2404
2000 x 2100/2400	2150 x 2175/2475	2158 x 2179/2479	1006	1016	2104/2404

PASSAGE SIZE <b>L x H</b>	FINISHED WALL 125		FINISHED WALL 150		
	OVERALL DIMENSIONS <b>C x H1</b>		OVERALL DIMENSIONS <b>C x H1</b>		
	PULL DOOR		PULL DOOR		
			DW1	DW2	DH
1200 x 2100/2400	1390 x 2195/2495	1432 x 2216/2516	606	616	2104/2404
1400 x 2100/2400	1590 x 2195/2495	1632 x 2216/2516	706	716	2104/2404
1600 x 2100/2400	1790 x 2195/2495	1832 x 2216/2516	806	816	2104/2404
1800 x 2100/2400	1990 x 2195/2495	2032 x 2216/2516	906	916	2104/2404
2000 x 2100/2400	2190 x 2195/2495	2232 x 2216/2516	1006	1016	2104/2404

FINISHED WALL = <b>FW</b>	SOLID WALL	STUD WALL	
	BRICKS = <b>Br</b>	STUDWORK = <b>S</b>	
100 →	--	50 with two plasterboard layers	75 with one plasterboard layer
108 →	80	--	--
125 →	100	75 with two plasterboard layers	100 with one plasterboard layer
150 →	120	100 with two plasterboard layers	

Dimensions are given in mm

### NOTES

- ▶ Supplied as standard with 3 hinges. Max. door panel weight with 3 hinges: 50 kg.
- ▶ Available upon request with 4 hinges. Max. door panel weight with 4 hinges: 65 kg.
- ▶ Available finishes: Primer-coated, Champagne, Bronze, Tobacco and White RAL 9010.
- ▶ Install at finished floor level.

### ACCESSORIES

- ▶ Self-closing door hinge